

CATALOGUE LABORATORY 2016

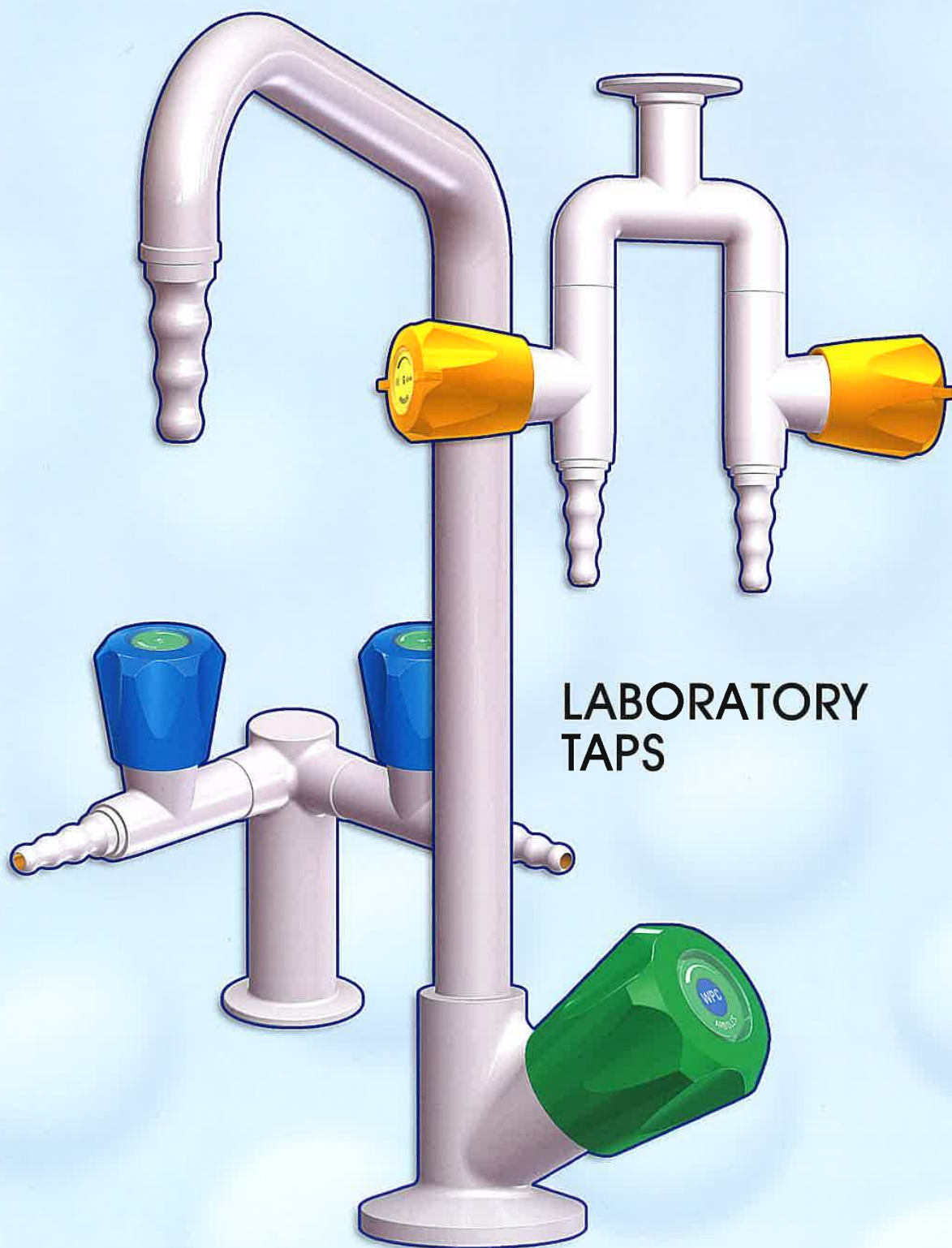

LABORATORY
TAPS



CARLOS ARBOLES S.A
LABORATORY TAPS

INDEX



TECHNICAL INFORMATION

PRESENTATION
TECHNICAL INFORMATION
DESIGN AND
MANUFACTURING

PAGES

1
2 - 3
4



WATER CONTROLS

BENCH MOUNTED
WALL MOUNTED
PENDANT MOUNTED

5 - 7
8 - 10
10 - 11



MIXER TAPS

BENCH MOUNTED
WALL MOUNTED

12
13



MONOBLOC MIXERS

BENCH MOUNTED

14



SPECIAL WATERS

STAINLESS STEEL
PLASTIC

25
26



GAS CONTROLS

BENCH MOUNTED
WALL MOUNTED
PENDANT MOUNTED

19 - 20
15 - 17
17 - 18



DRY SERVICE CONTROLS

BENCH MOUNTED
WALL MOUNTED
PENDANT MOUNTED

PAGES

21
22 - 23
23 - 24



FRONT CONTROLS

VALVES
OUTLETS

27
28 - 29



LABORATORY SINKS

CERAMIC

30



ELECTRIC SOCKETS

BENCH MOUNTED

30



ACCESSORIES

ACCESSORIES
SPARE PARTS

31
32



CARLOS ARBOLES S.A.
LABORATORY TAPS

CATALOGUE OF LABORATORY TAPS



Since 1929, Arboles manufactures tap fittings of diverse types and applications; we now specialise in two product lines:

- **EMERGENCY SHOWERS AND EYEWASHES**
- **TAP FITTINGS FOR LABORATORIES**

Carlos Arboles, S.A. is certified to ISO 9001, and all the products manufactured in the company are made under strict quality standards.

Since 1944 we have been supplying the international with a full range of Laboratory Taps.

In this catalogue we show our current models.



CARLOS ARBOLES S.A
LABORATORY TAPS

TECHNICAL CHARACTERISTICS

Carlos Arboles, S.A. supplies full range of Water, Gas and Special water Laboratory Taps, designed and manufactured to be extremely reliable. Different configurations are available to achieve the flexibility required in every laboratory.

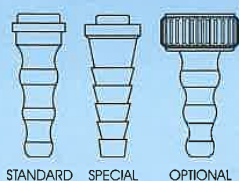

NOZZLES

- Fixed or removable
- Different shapes
- Safety function
- Water efficient

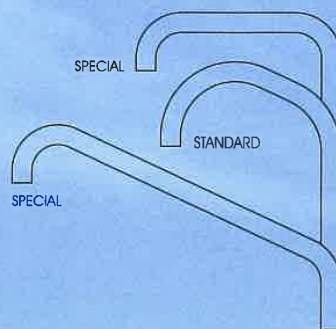

DIMENSIONS

- Shapes in "J" form, Square or Round
- Standout and useful Heights

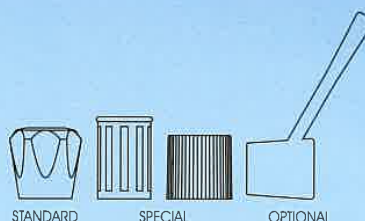

HANDLES

- Ergonomical shapes
- Various Designs
- Wrist action Lever

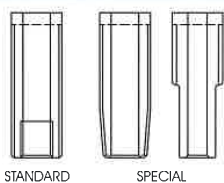

INLET

- Female or Male Threads
- Parallel or Tapered
- Push fitting
- Antirotation

ORDERING PROCESS

Before ordering please consider:
STANDARD: As coded in this catalogue
OPTIONAL: To be specified in the order, will include price supplement
SPECIAL: Requires minimum quantity and longer manufacturing time



TECHNICAL CHARACTERISTICS

VALVES

WATER FITTINGS

Longlife renewable cartridges with either compression non-rising spindle or with 1/4 turn ceramic disc. Special fittings with WRAS and Watermark approvals. Working conditions: 10 bar, 65° C.

GAS FITTINGS

Brass taps with safety cartridge. DVGW and AGA approvals. The push and 1/4 turn ceramic cartridge has a safety locking mechanism that prevents accidental opening. Working conditions: 0,2 bar, 60° C.

OTHER GASES AND FLUIDS

Brass taps with needle valve. These valves have a fine pitch and PTFE seal for positive shut-off. Supplied with an exchangeable seat, these valves can regulate the flow rate finely. Working conditions: 10 bar, 60° C.

SPECIAL WATERS FITTINGS

For purified water, plastic, polyethylene lined or stainless steel taps with 1/4 metal free ceramic headwork. Working conditions: 4 bar, 48° C.

COLOURS



All our taps are coated with anticorrosive polyamide 11 with a thickness of 250-300 microns.

- This coating is resistant to base chemicals, organic acids, diluted mineral acids and aliphatic solvents.
- It does not stick to surface neither fungi nor microorganisms.
- Made from a vegetable raw material, it does not contain VOCs or heavy metals (chrome, nickel and lead).

TAPS COATING COLOURS

Light grey	White	Dark grey	Black	Graphite	Silver
STANDARD		OPTIONAL		SPECIAL	

APPROVALS



- Laboratory Taps are designed and manufactured according to EN 13792, DIN 12898 and DIN 12918.1-2-3.
- Different international approvals for our range of water and gas taps, English WRAS, German DIN DVGW, Australian WATERMARK and AGA.



DESIGN AND MANUFACTURING

CAD/CAM
TECHNICAL
DEPARTMENT



PRODUCTS ARE
100% LEAK TESTED

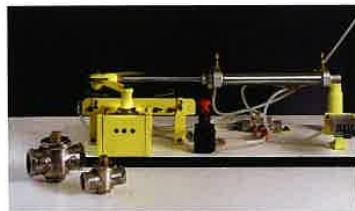

MECHANICAL TESTING

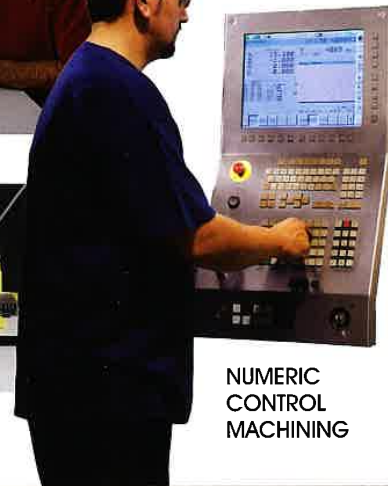

NUMERIC
CONTROL
MACHINING



CNC MACHINING



WATER CONTROLS BENCH MOUNTED

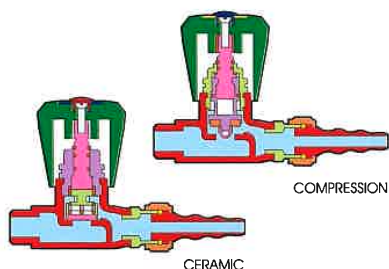

TECHNICAL FEATURES

Media: Water
Maximum pressure: 10 bar
Fluid identification according to DIN-EN 13792:



Design according to DIN 12918-1
Nozzle according to DIN 12898

Main materials: Brass Body
Headwork: Brass, compression sealing
Optional: Long life 1/4 turn ceramic headwork
Handwheel: Green ABS
Anticorrosive coating: Polyamide 11, light grey colour RAL 7035
Mounting hole: 22 mm for G 1/2" and 17 mm for G 3/8"

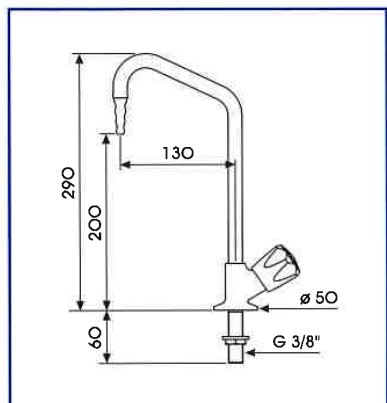

FIXED SWANNECK FIXED NOZZLE OUTLET, COMPRESSION WATER HEADWORK

- 6101 LEFT HAND CONTROL
- 6102 REAR HAND CONTROL
- 6103 RIGHT HAND CONTROL

Other options:
- Ceramic water headwork
- Removable nozzle

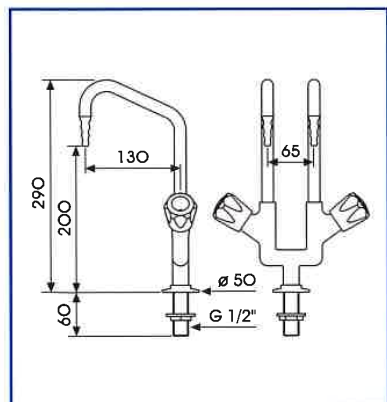

6104 TWO WAY FIXED SWANNECK, FIXED NOZZLE OUTLET, COMPRESSION WATER HEADWORK

Other options:
- Ceramic water headwork
- Removable nozzle

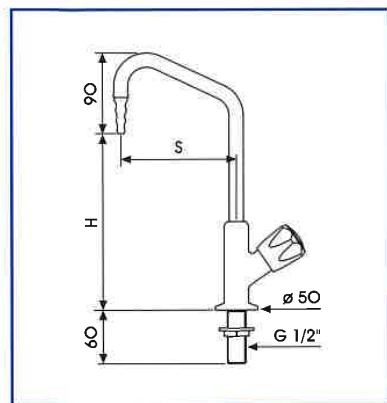

SWIVEL SWANNECK, FIXED NOZZLE OUTLET, COMPRESSION WATER HEADWORK

- 6105 H=200 mm S=130 mm
- 6106 H=240 mm S=130 mm
- 6107 H=240 mm S=200 mm

Other options:
- Ceramic water headwork
- Removable nozzle



WATER CONTROLS BENCH MOUNTED

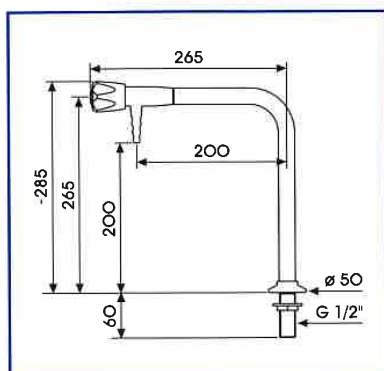

6120 BIB TAP, FIXED NOZZLE
OUTLET, COMPRESSION
WATER HEADWORK

Other options:
- Ceramic water headwork
- Removable nozzle

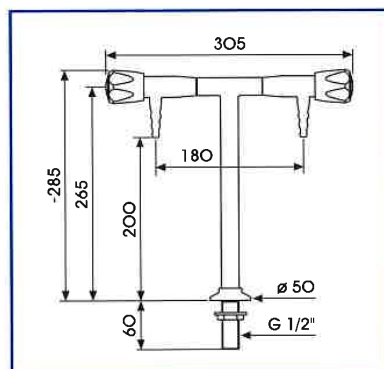

6122 TWO WAY BIB TAP AT 180°,
FIXED NOZZLE OUTLET,
COMPRESSION WATER
HEADWORK

Other options:
- Ceramic water headwork
- Removable nozzle

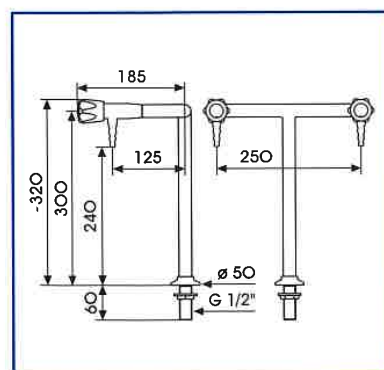

6124 TWO WAY BIB TAP "U",
FIXED NOZZLE OUTLET
COMPRESSION WATER
HEADWORK

Other options:
- Ceramic water headwork
- Removable nozzle

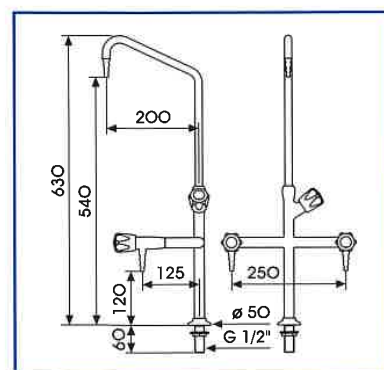

6126 THREE WAY BIB TAP, FIXED
NOZZLE OUTLET,
COMPRESSION WATER
HEADWORK

Other options:
- Ceramic water headwork
- Removable nozzle



WATER CONTROLS BENCH MOUNTED

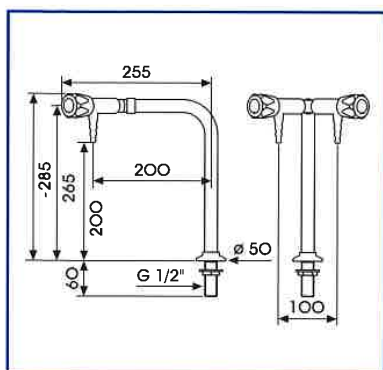

6128 TWO WAY BIB TAP "Y",
FIXED NOZZLE OUTLET,
COMPRESSION WATER
HEADWORK

Other options:
- Ceramic water headwork
- Removable nozzle

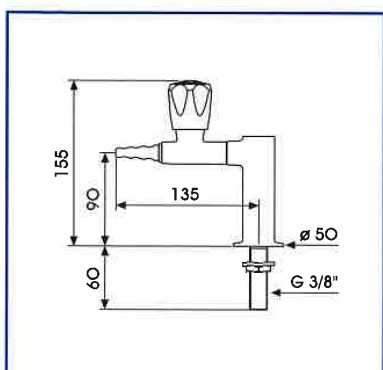

6201 SINGLE TAP, FIXED NOZZLE
OUTLET, COMPRESSION
WATER HEADWORK

Other options:
- Ceramic water headwork
- Removable nozzle

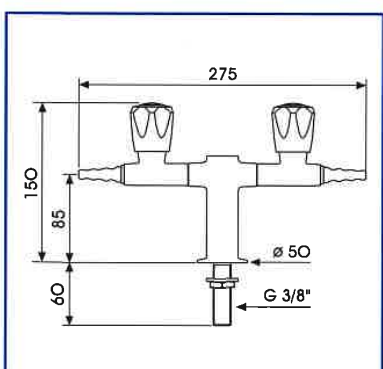

6202 TWO WAY TAP AT 180°,
FIXED NOZZLE OUTLET,
COMPRESSION WATER
HEADWORK

Other options:
- Ceramic water headwork
- Removable nozzle

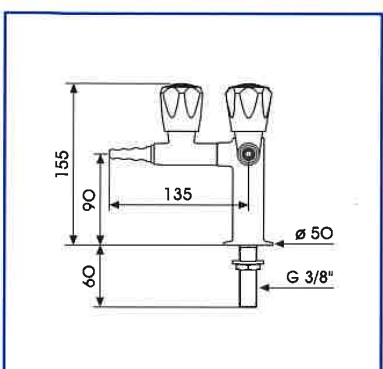

6203 TWO WAY TAP AT 90°,
FIXED NOZZLE OUTLET,
COMPRESSION WATER
HEADWORK

Other options:
- Ceramic water headwork
- Removable nozzle



WATER CONTROLS WALL MOUNTED

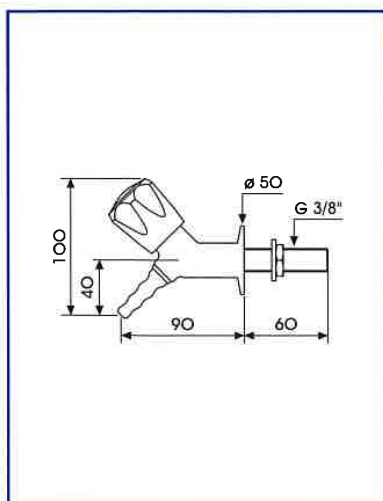

6284 BIB TAP, FIXED NOZZLE
OUTLET AT 45°,
COMPRESSION WATER
HEADWORK

Other options:
- Ceramic water headwork
- Removable nozzle

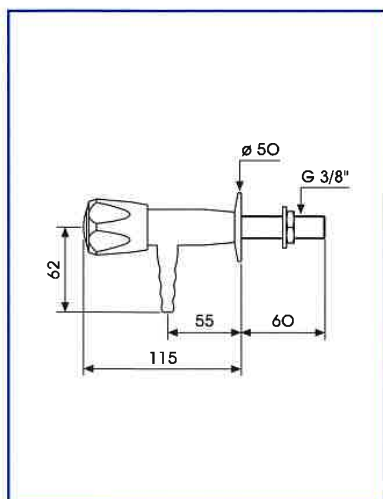

6721 ANGLE TAP, FIXED
NOZZLE OUTLET,
COMPRESSION WATER
HEADWORK

Other options:
- Ceramic water headwork
- Removable nozzle

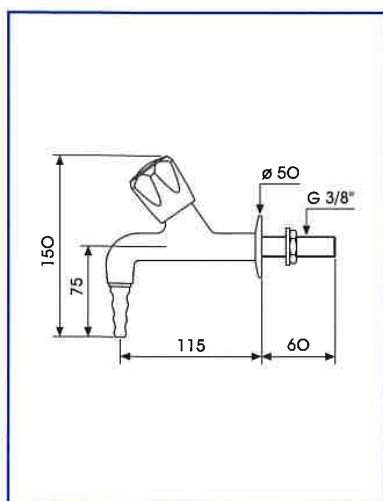

6802 BIB TAP, FIXED NOZZLE
OUTLET AT 90°,
COMPRESSION WATER
HEADWORK

Other options:
- Ceramic water headwork
- Removable nozzle



WATER CONTROLS WALL MOUNTED

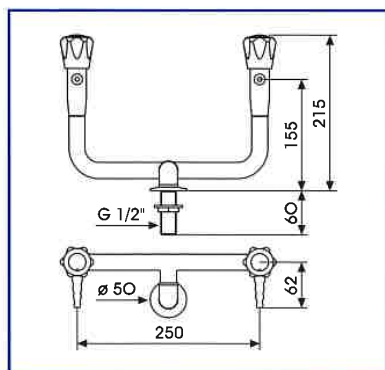

6810 TWO WAY BIB TAP,
FIXED NOZZLE OUTLET,
COMPRESSION WATER
HEADWORK

Other options:
- Ceramic water headwork
- Removeable nozzle

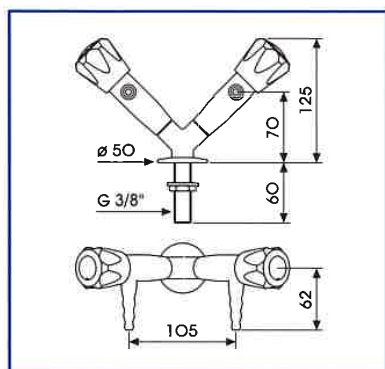

6818 TWO WAY ANGLE TAP,
FIXED NOZZLE OUTLET,
COMPRESSION WATER
HEADWORK

Other options:
- Ceramic water headwork
- Removeable nozzle

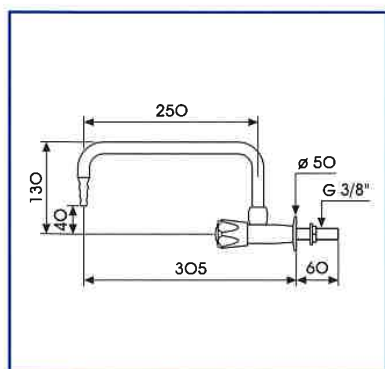

6870 MOVABLE SWANNECK,
FIXED NOZZLE OUTLET,
COMPRESSION WATER
HEADWORK

Other options:
- Ceramic water headwork
- Removeable nozzle

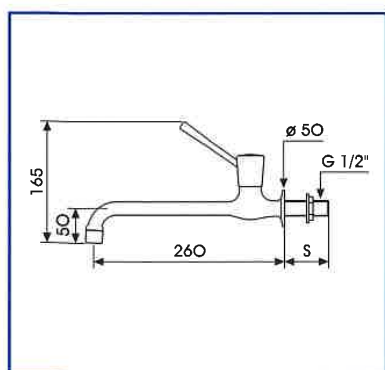

**BIB TAP, AERATOR, WRIST
ACTION LEVER, CERAMIC
HEADWORK**

6955 S=60 mm
955 S=12 mm



WATER CONTROLS WALL/PENDANT MOUNTED

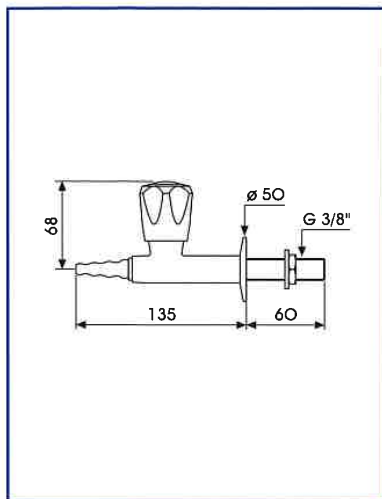

6815 IN LINE TAP, FIXED NOZZLE OUTLET, COMPRESSION WATER HEADWORK

Other options:
 - Ceramic water headwork
 - Removable nozzle

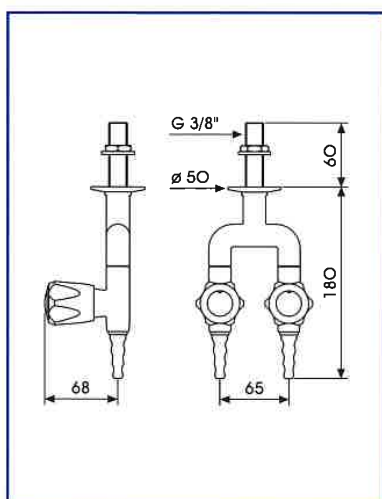

6816 TWO WAY IN LINE TAP "U", FIXED NOZZLE OUTLET, COMPRESSION WATER HEADWORK

Other options:
 - Ceramic water headwork
 - Removable nozzle

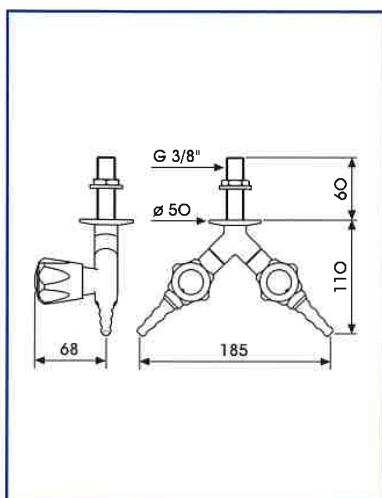

6817 TWO WAY IN LINE TAP "Y", FIXED NOZZLE OUTLET, COMPRESSION WATER HEADWORK

Other options:
 - Ceramic water headwork
 - Removable nozzle



WATER CONTROLS PENDANT MOUNTED

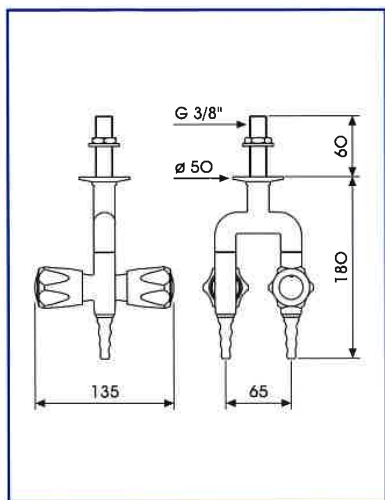

6216 TWO WAY IN LINE TAP, FIXED NOZZLE OUTLET, COMPRESSION WATER HEADWORK

Other options:
- Ceramic water headwork
- Removable nozzle

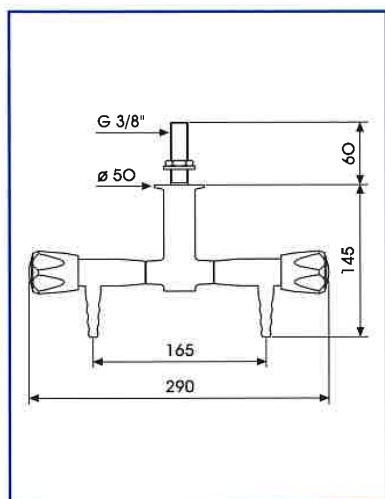

6222 TWO WAY ANGLE TAP AT 180°, FIXED NOZZLE OUTLET, COMPRESSION WATER HEADWORK

Other options:
- Ceramic water headwork
- Removable nozzle

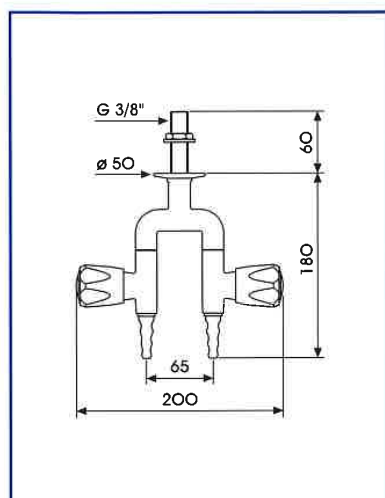

6416 TWO WAY IN LINE TAP, FIXED NOZZLE OUTLET, COMPRESSION WATER HEADWORK

Other options:
- Ceramic water headwork
- Removable nozzle



MIXER TAPS BENCH MOUNTED

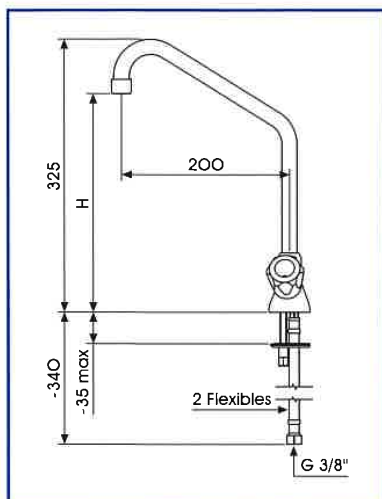

SWIVEL SWANNECK, COMPRESSION WATER HEADWORK

- 115 WITH AERATOR
H=260 mm
- 116 WITH REMOVABLE
NOZZLE
H=215 mm

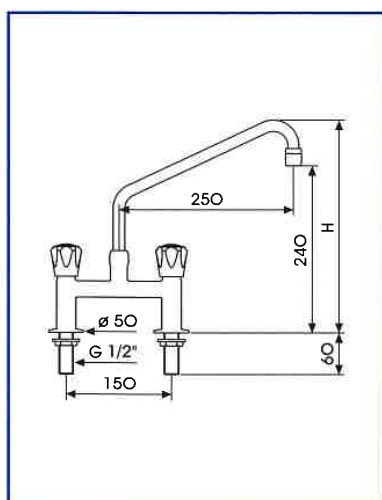

SWIVEL SWANNECK, 150 mm CENTRES, COMPRESSION WATER HEADWORK

- 6140 WITH AERATOR
H=305 mm
- 6141 WITH FIXED NOZZLE
H=330 mm
- 6142 WITH REMOVABLE
NOZZLE
H=335 mm

Other options:
- Ceramic water headwork

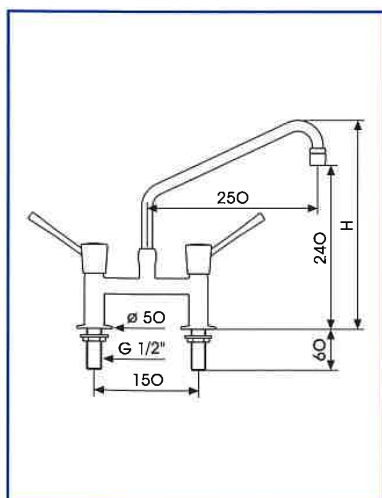

SWIVEL SWANNECK, WRIST ACTION LEVER, CERAMIC WATER HEADWORK

- 6155 WITH AERATOR
H=305 mm
- 6156 WITH FIXED NOZZLE
H=330 mm
- 6157 WITH REMOVABLE
NOZZLE
H=335 mm



MIXER TAPS WALL MOUNTED

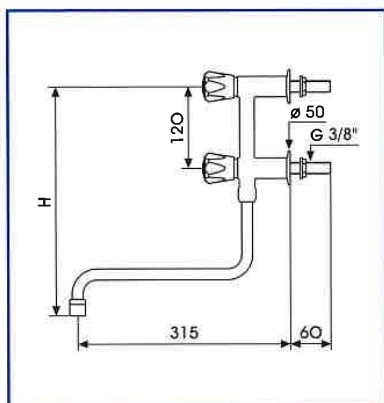

SWIVEL SWANNECK, COMPRESSION WATER HEADWORK

- 6160** WITH AERATOR H=310 mm
- 6161** WITH FIXED NOZZLE H=330 mm
- 6162** WITH REMOVABLE NOZZLE H=335 mm

Other options:
- Ceramic water headwork

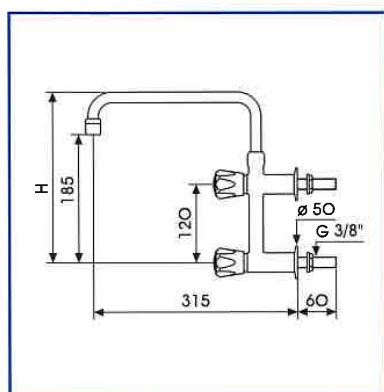

SWIVEL SWANNECK, COMPRESSION WATER HEADWORK

- 6170** WITH AERATOR H=250 mm
- 6171** WITH FIXED NOZZLE H=270 mm
- 6172** WITH REMOVABLE NOZZLE H=280 mm

Other options:
- Ceramic water headwork

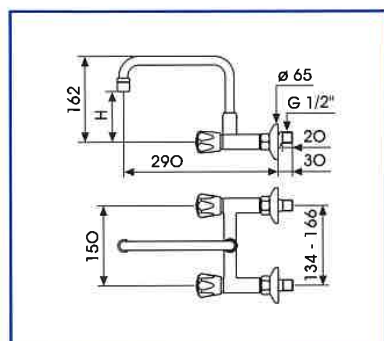

SWIVEL SWANNECK, 150 mm ADJUSTABLE CENTRES, COMPRESSION WATER HEADWORK

- 812** WITH AERATOR H=95 mm
- 813** WITH FIXED NOZZLE H=70 mm
- 814** WITH REMOVABLE NOZZLE H=70 mm

Other options:
- Ceramic water headwork

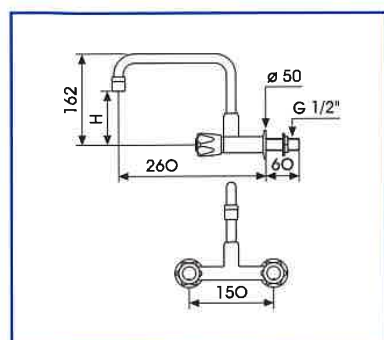

SWIVEL SWANNECK, 150 mm CENTRES, COMPRESSION WATER HEADWORK

- 6190** WITH AERATOR H=95 mm
- 6191** WITH FIXED NOZZLE H=70 mm
- 6192** WITH REMOVABLE NOZZLE H=70 mm

Other options:
- Ceramic water headwork



CARLOS ARBOLES S.A
LABORATORY TAPS

MONOBLOC MIXER TAPS BENCH MOUNTED

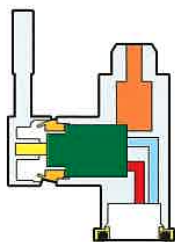

TECHNICAL FEATURES

Media: Hot/cold water
Maximum pressure: 5 bar
Design according to DIN 12918-1 and EN 200
Nozzle according to DIN 12898
Main materials: Brass Body
Headwork: 35 mm ceramic cartridge
Lever: Brass

Anticorrosive coating: Polyamide 11, light grey colour RAL 7035
Mounting hole: 35-37 mm

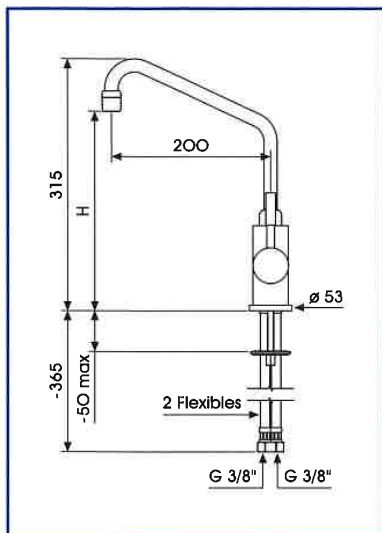

MONOBLOC SINGLE HANDLE MIXER WITH SWIVEL SWANNECK

310 WITH AERATOR H=250 mm

311 WITH FIXED NOZZLE OUTLET H=225 mm

312 WITH REMOVABLE NOZZLE H=220 mm

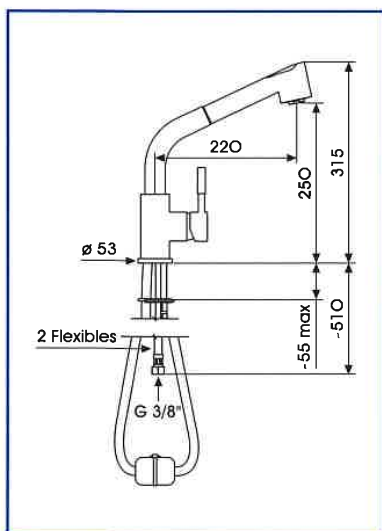

320 MONOBLOC SINGLE HANDLE MIXER WITH PULL-OUT SHOWER



GAS CONTROLS WALL MOUNTED

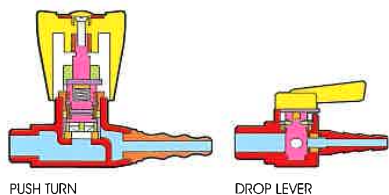

PUSH TURN

DROP LEVER

TECHNICAL FEATURES

Media: Burning gas

Maximum pressure: 0,2 bar

Fluid identification according to DIN-EN 13792:



Design according to DIN 12918-2

Nozzle according to DIN 12898

Main materials: Brass Body

Headwork: 1/4 Push-Turn ceramic headwork with safety locking

Drop lever: 1/4 plug type with safety locking

Handwheel: Yellow ABS

Anticorrosive coating: Polyamide 11, light grey colour RAL 7035

Mounting hole: 17 mm for G 3/8"

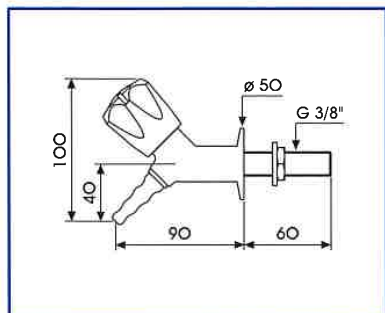

6384 BIB TAP, FIXED NOZZLE OUTLET, PUSH-TURN GAS HEADWORK

Other options:
- Removable nozzle

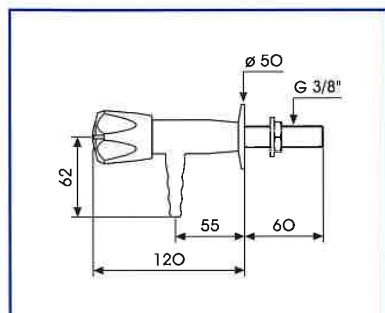

6731 ANGLE TAP, FIXED NOZZLE OUTLET, PUSH-TURN GAS HEADWORK

Other options:
- Removable nozzle



CARLOS ARBOLES S.A
LABORATORY TAPS

DROP LEVER/GAS CONTROLS WALL MOUNTED

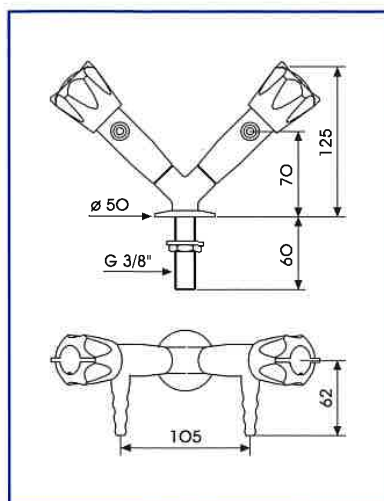

6838 TWO WAY ANGLE
TAP, FIXED
NOZZLE OUTLET,
PUSH-TURN GAS
HEADWORK

Other options:
- Removable nozzle

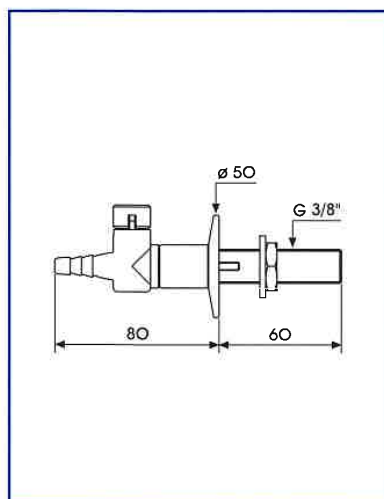

**DROP LEVER GAS TAP
WALL MOUNTED**

800035 AR
SINGLE DROP LEVER TAP
800035 NN
FITTED WITH NON-RETURN
VALVE AND RESTRICTOR

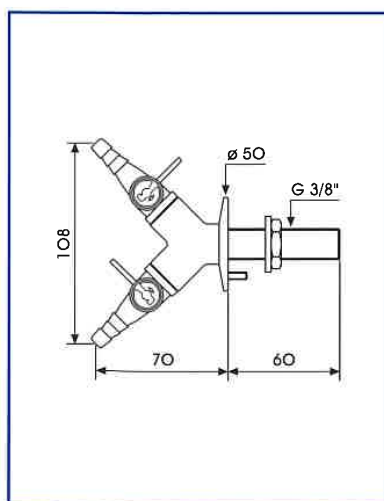

**DROP LEVER GAS TAP
WALL MOUNTED**

800036 AR
TWO WAY DROP LEVER
TAP
800036 NN
FITTED WITH NON-RETURN
VALVES AND RESTRICTORS



GAS CONTROLS WALL/PENDANT MOUNTED

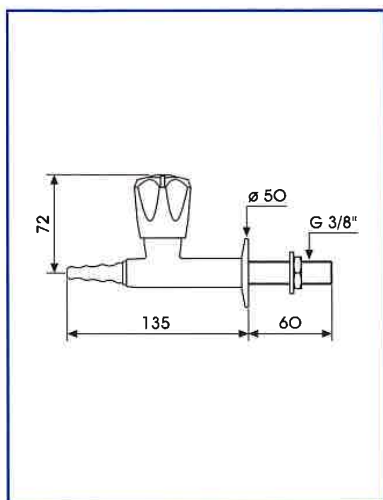

6831 IN LINE TAP, FIXED NOZZLE OUTLET, PUSH-TURN GAS HEADWORK

Other options:
- Removable nozzle

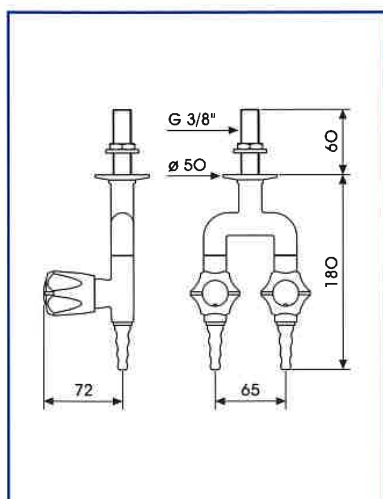

6832 TWO WAY IN LINE TAP "U", FIXED NOZZLE OUTLET, PUSH-TURN GAS HEADWORK

Other options:
- Removable nozzle

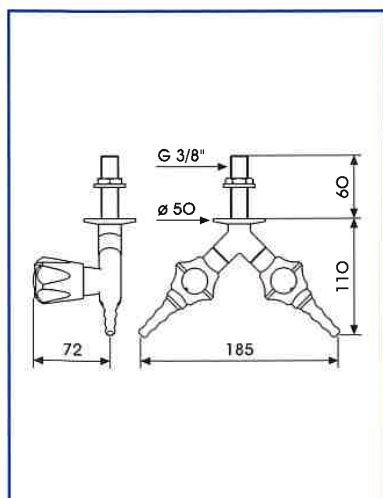

6833 TWO WAY IN LINE TAP "Y", FIXED NOZZLE OUTLET, PUSH-TURN GAS HEADWORK

Other options:
- Removable nozzle



GAS CONTROLS PENDANT MOUNTED

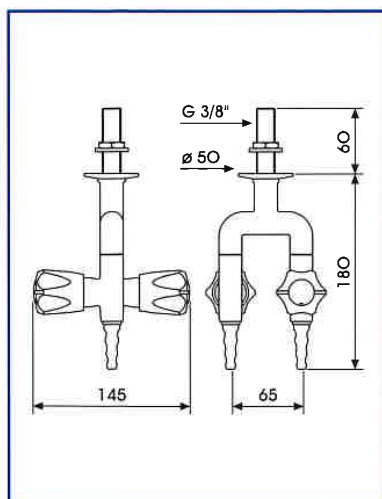

6232 TWO WAY IN LINE
TAP, FIXED NOZZLE
OUTLET, PUSH-TURN
GAS HEADWORK

Other options:
- Removable nozzle

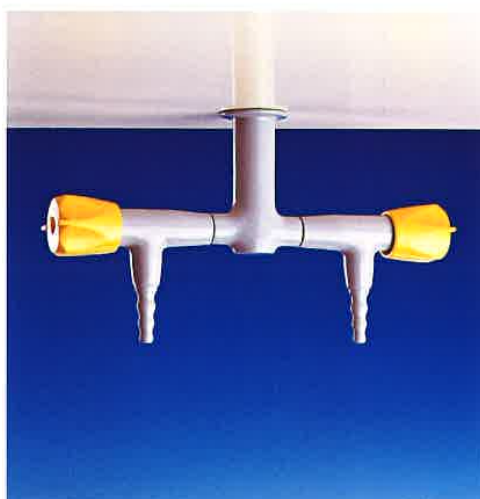
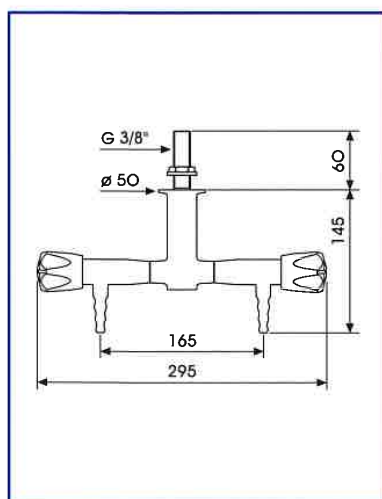

6322 TWO WAY ANGLE
TAP AT 180°,
FIXED NOZZLE
OUTLET, PUSH-TURN
GAS HEADWORK

Other options:
- Removable nozzle

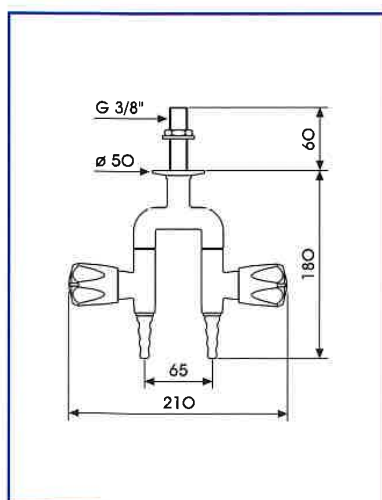

6432 TWO WAY IN LINE
TAP, FIXED NOZZLE
OUTLET, PUSH-TURN
GAS HEADWORK

Other options:
- Removable nozzle



GAS CONTROLS BENCH MOUNTED

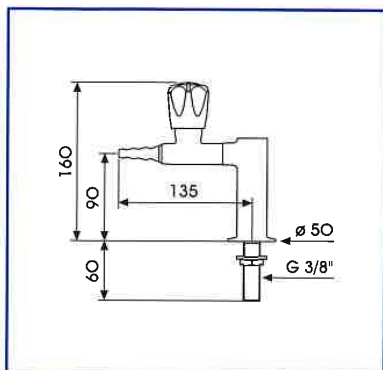

6301 SINGLE TAP, FIXED NOZZLE OUTLET, PUSH-TURN GAS HEADWORK

Other options:
- Removable nozzle

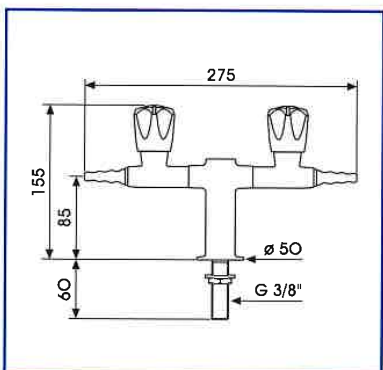

6302 TWO WAY TAP AT 180°, FIXED NOZZLE OUTLET, PUSH-TURN GAS HEADWORK

Other options:
- Removable nozzle

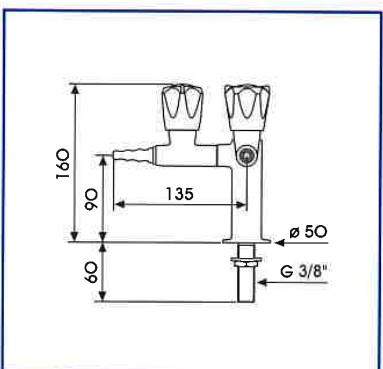

6303 TWO WAY TAP AT 90°, FIXED NOZZLE OUTLET, PUSH-TURN GAS HEADWORK

Other options:
- Removable nozzle

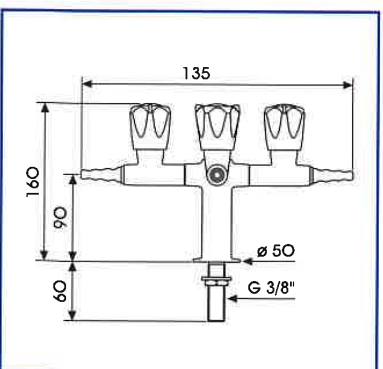

6304 FOUR WAY TAP, FIXED NOZZLE, PUSH-TURN HEADWORK

Other options:
- Removable nozzle



DROP LEVER CONTROLS BENCH MOUNTED

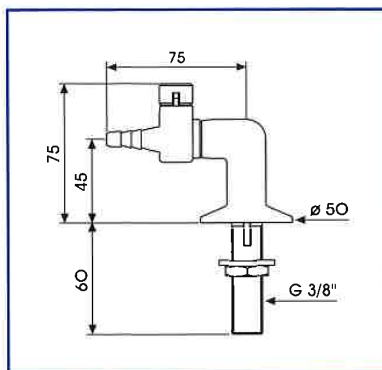

800031 AR
SINGLE DROP LEVER TAP
800031 NN
FITTED WITH NON-RETURN
VALVE AND RESTRICTOR

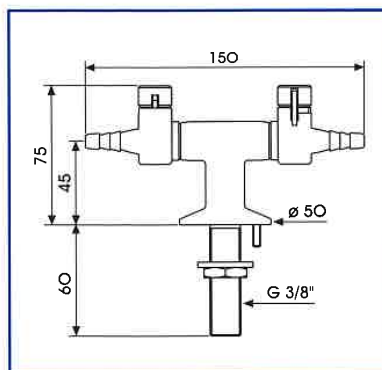

800032 AR
TWO WAY DROP LEVER TAP
AT 180°
800032 NN
FITTED WITH NON-RETURN
VALVES AND RESTRICTORS

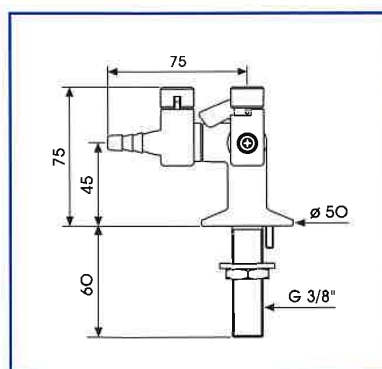

800033 AR
TWO WAY DROP LEVER TAP
AT 90°
800033 NN
FITTED WITH NON-RETURN
VALVES AND RESTRICTORS

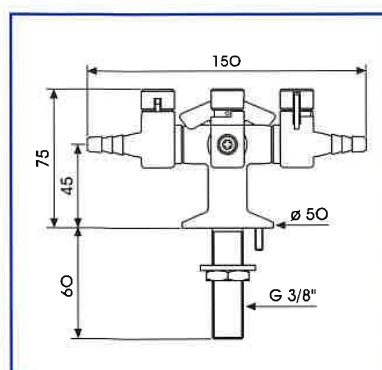

800034 AR
FOUR WAY DROP LEVER TAP
800034 NN
FITTED WITH NON-RETURN
VALVES AND RESTRICTORS



DRY SERVICE CONTROLS BENCH MOUNTED

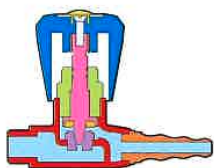

TECHNICAL FEATURES

Media: Dry services

Maximum pressure: 10 bar

Fluid identification according to DIN-EN 13792:



Design according to DIN 12918-3

Nozzle according to DIN 12898

Main materials: Brass Body

Headwork: Needle Brass valve, PTFE compression sealing

Handwheel: ABS

Anticorrosive coating: Polyamide 11, light grey colour RAL 7035

Mounting hole: 17 mm for G 3/8"

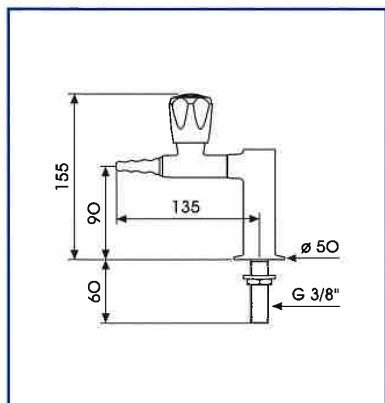

SINGLE TAP, FIXED NOZZLE OUTLET, NEEDLE HEADWORK

6401 FOR VACUUM

6501 FOR COMPRESSED AIR

6601 FOR OTHER PRESSURE GASES

(INDICATE GAS/FLUID)

6801 FOR OXYGEN

Other options:

- Removable nozzle

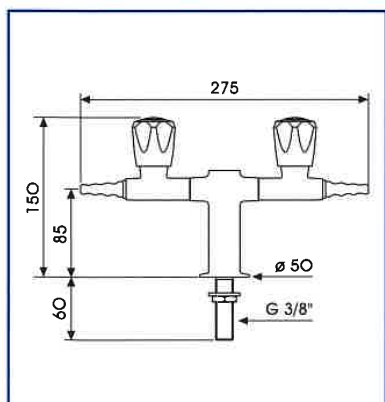

TWO WAY TAP AT 180°, FIXED NOZZLE OUTLET, NEEDLE HEADWORK

6402 FOR VACUUM

6502 FOR COMPRESSED AIR

6602 FOR OTHER PRESSURE GASES

(INDICATE GAS/FLUID)

6808 FOR OXYGEN

Other options:

- Removable nozzle

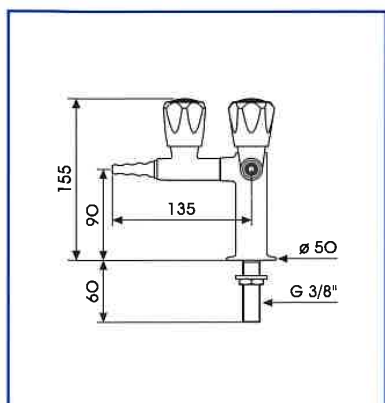

TWO WAY TAP AT 90°, FIXED NOZZLE OUTLET, NEEDLE HEADWORK

6403 FOR VACUUM

6503 FOR COMPRESSED AIR

6603 FOR OTHER PRESSURE GASES

(INDICATE GAS/FLUID)

6803 FOR OXYGEN

Other options:

- Removable nozzle



DRY SERVICE CONTROLS WALL MOUNTED

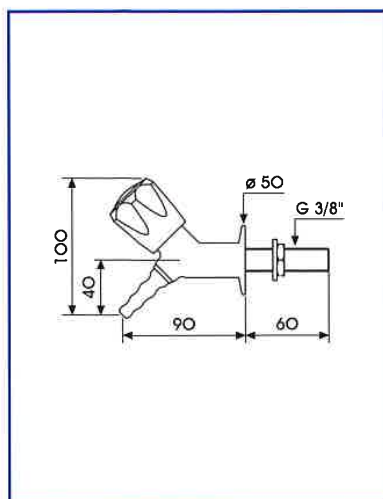

BIB TAP, FIXED NOZZLE OUTLET, NEEDLE HEADWORK

- 6484** FOR VACUUM
- 6584** FOR COMPRESSED
AIR
- 6684** FOR OTHER
PRESSURE GASES
(INDICATE
GAS/FLUID)
- 6884** FOR OXYGEN

Other options:
- Removable nozzle

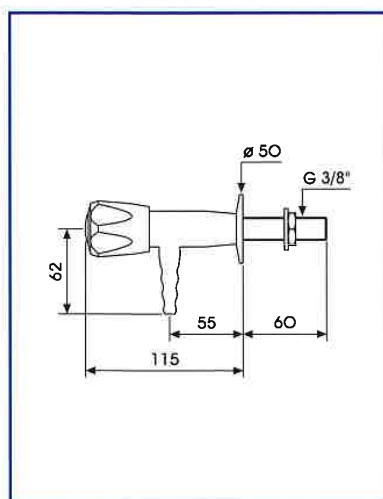

ANGLE TAP, FIXED NOZZLE OUTLET, NEEDLE HEADWORK

- 6741** FOR VACUUM
- 6751** FOR COMPRESSED
AIR
- 6761** FOR OTHER
PRESSURE GASES
(INDICATE
GAS/FLUID)
- 6781** FOR OXYGEN

Other options:
- Removable nozzle

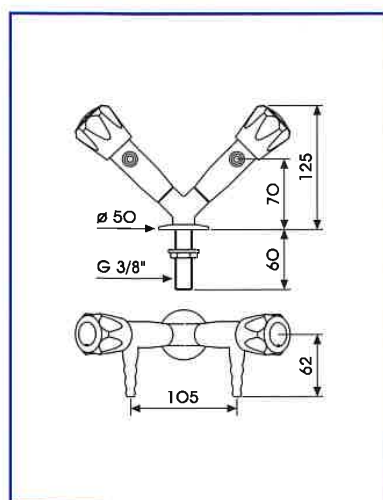

TWO WAY ANGLE TAP, FIXED NOZZLE OUTLET, NEEDLE HEADWORK

- 6848** FOR VACUUM
- 6858** FOR COMPRESSED
AIR
- 6868** FOR OTHER
PRESSURE GASES
(INDICATE
GAS/FLUID)
- 6888** FOR OXYGEN

Other options:
- Removable nozzle



DRY SERVICE CONTROLS WALL/PENDANT MOUNTED

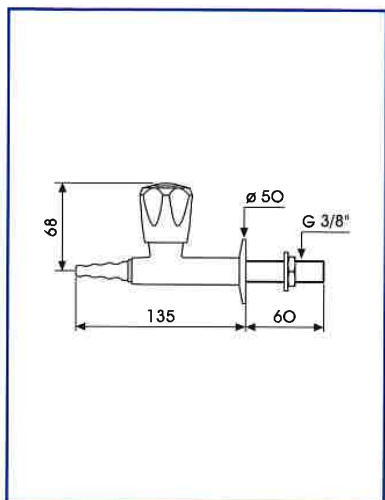

IN LINE TAP, FIXED NOZZLE OUTLET, NEEDLE HEADWORK

- 6841** FOR VACUUM
- 6851** FOR COMPRESSED AIR
- 6861** FOR OTHER PRESSURE GASES
(INDICATE GAS/FLUID)
- 6881** FOR OXYGEN

Other options:

- Removable nozzle

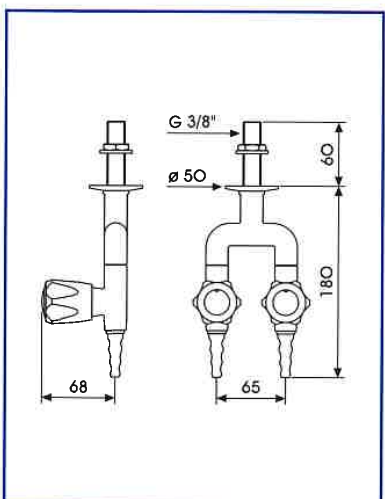

TWO WAY IN LINE TAP "U", FIXED NOZZLE OUTLET, NEEDLE HEADWORK

- 6842** FOR VACUUM
- 6852** FOR COMPRESSED AIR
- 6862** FOR OTHER PRESSURE GASES
(INDICATE GAS/FLUID)
- 6882** FOR OXYGEN

Other options:

- Removable nozzle

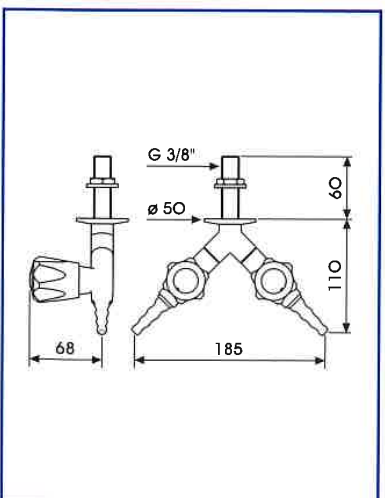

TWO WAY IN LINE TAP "Y", FIXED NOZZLE OUTLET, NEEDLE HEADWORK

- 6843** FOR VACUUM
- 6853** FOR COMPRESSED AIR
- 6863** FOR OTHER PRESSURE GASES
(INDICATE GAS/FLUID)
- 6883** FOR OXYGEN

Other options:

- Removable nozzle



CARLOS ARBOLES S.A.
LABORATORY TAPS

DRY SERVICE CONTROLS PENDANT MOUNTED

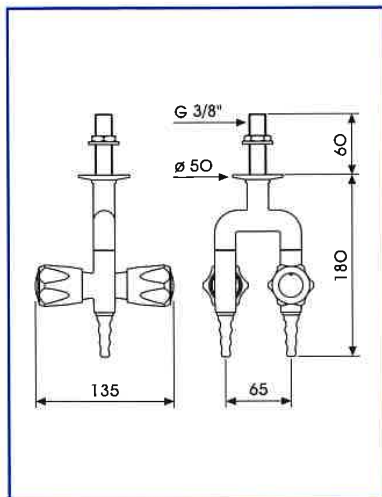

TWO WAY IN LINE TAP, FIXED NOZZLE OUTLET, NEEDLE HEADWORK

- 6242** FOR VACUUM
- 6252** FOR COMPRESSED AIR
- 6262** FOR OTHER PRESSURE GASES
(INDICATE GAS/FLUID)
- 6282** FOR OXYGEN

Other options:
- Removable nozzle

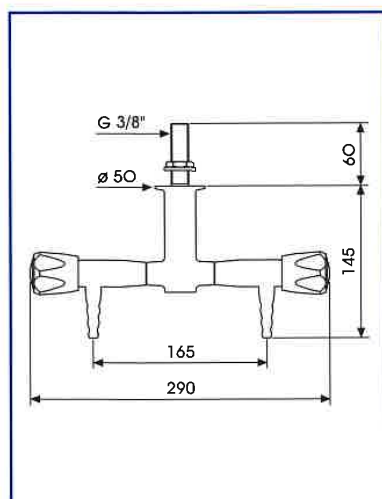

TWO WAY ANGLE TAP AT 180°, FIXED NOZZLE OUTLET, NEEDLE HEADWORK

- 6422** FOR VACUUM
- 6522** FOR COMPRESSED AIR
- 6622** FOR OTHER PRESSURE GASES
(INDICATE GAS/FLUID)
- 6822** FOR OXYGEN

Other options:
- Removable nozzle

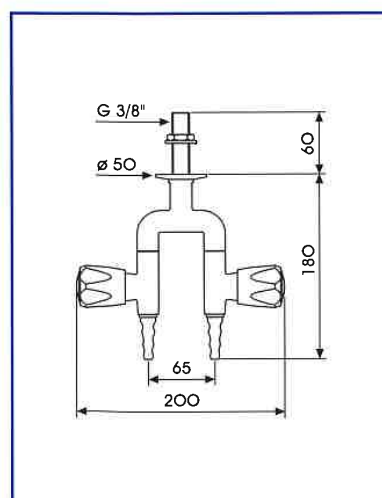

TWO WAY IN LINE TAP, FIXED NOZZLE OUTLET, NEEDLE HEADWORK

- 6442** FOR VACUUM
- 6452** FOR COMPRESSED AIR
- 6462** FOR OTHER PRESSURE GASES
(INDICATE GAS/FLUID)
- 6482** FOR OXYGEN

Other options:
- Removable nozzle



STAINLESS STEEL CONTROLS FOR SPECIAL WATERS

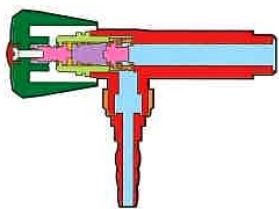

TECHNICAL FEATURES

Media: Purified water

Maximum pressure: 4 bar

Fluid identification according to DIN-EN 13792:



Design according to DIN 12918-1

Nozzle according to DIN 12898

Main materials: 304 Stainless Steel

Headwork: 1/4 metal free ceramic headwork

Handwheel: Green ABS

Anticorrosive coating: Polyamide 11, light grey colour RAL 7035

Mounting hole: 17 mm for G 3/8"

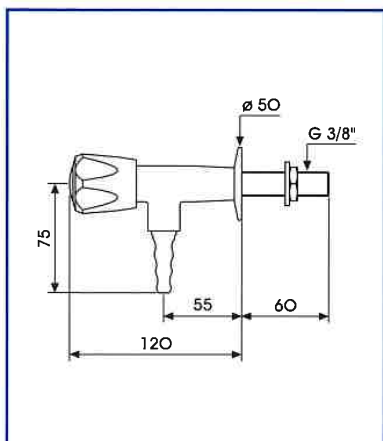

6198 ANGLE TAP, FIXED NOZZLE OUTLET, SPECIAL WATER HEADWORK, WALL MOUNTED

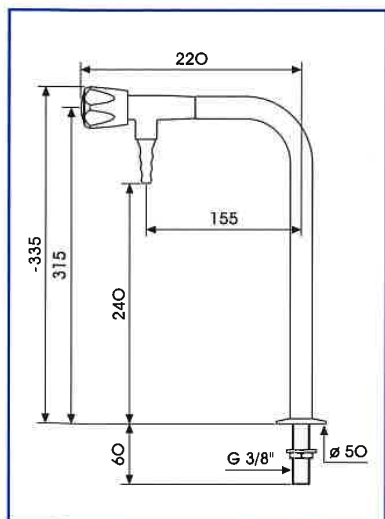

6199 BIB TAP, FIXED NOZZLE OUTLET, SPECIAL WATER HEADWORK, BENCH MOUNTED



PLASTIC CONTROLS FOR SPECIAL WATERS

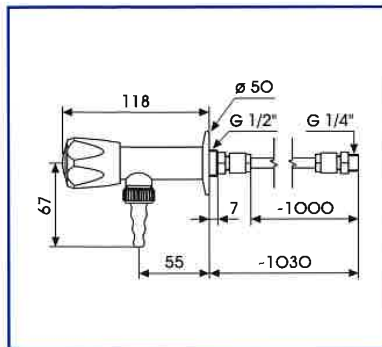

298 PP ANGLE TAP,
REMOVABLE
NOZZLE, WALL
MOUNTED, 1/4" PE
TUBE INLET,
SPECIAL WATER
HEADWORK

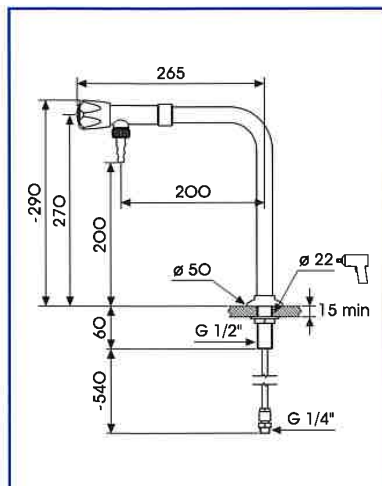

6299 PP BIB TAP,
REMOVABLE
NOZZLE, BENCH
MOUNTED, 1/4" PE
TUBE INLET,
SPECIAL WATER
HEADWORK

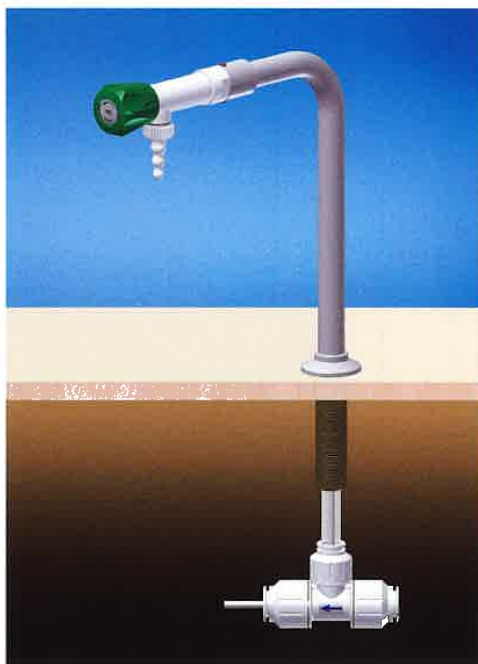
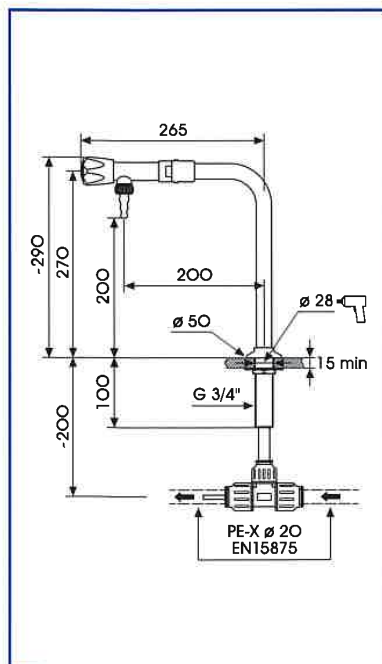

295 PP RECIRCULATING
BIB TAP,
REMOVABLE
NOZZLE, BENCH
MOUNTED,
PE LINED
COLUMN, DN20
PUSH-FIT PE INLET,
SPECIAL WATER
HEADWORK

Designed for applications where fully recirculation of special waters is required to avoid stagnant water and to prevent bacteria build-up. Adjustable mounting connection for easy installation.



FRONT CONTROL VALVES

WATER: Compression headwork

GAS: Push-Turn ceramic headwork

OTHER GASES: Needle headwork

SPECIAL WATERS: Plastic-Ceramic headwork

Carlos Arboles, S.A. manufactures full range of valves and outlets for fume hoods, providing two different solutions depending on installation choice:

- Front control valve, threaded body with brazed copper tubes
- Front control valve, body with G 1/4" connections

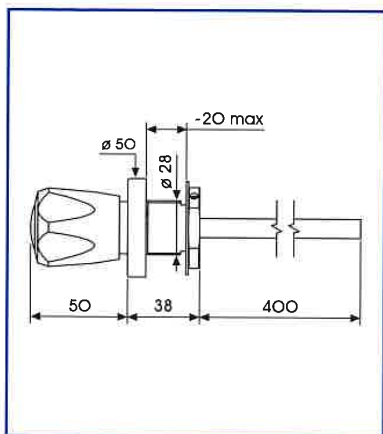

FRONT CONTROL VALVE, INLET AND OUTLET TUBE 10 x 1

1701 FOR WATER

Other options:

- Ceramic water headwork

1703 FOR GAS

1704 FOR VACUUM

1705 FOR COMPRESSED AIR

1706 FOR OTHER PRESSURE
GASES

(INDICATE GAS/FLUID)

1707 SS FOR SPECIAL WATERS

1708 FOR OXYGEN

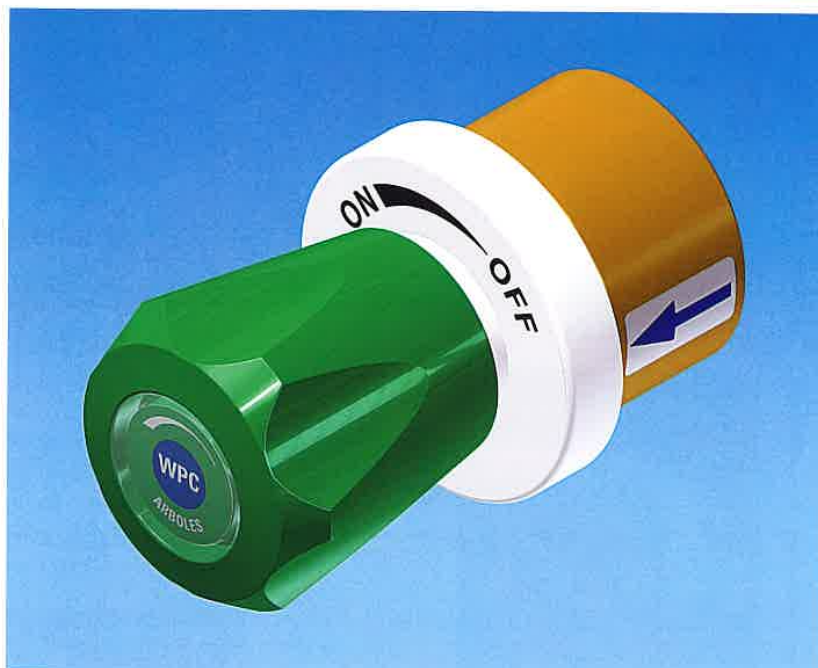
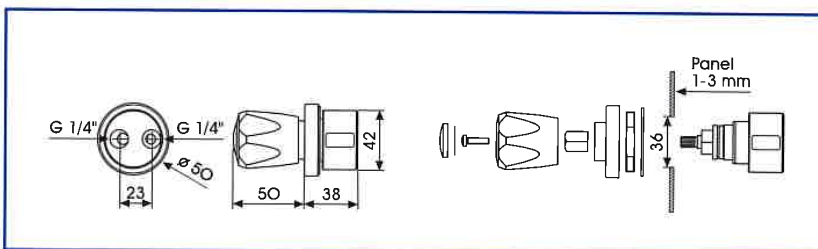

FRONT CONTROL VALVE, INLET AND OUTLET G 1/4" FEMALE

1711 FOR WATER

Other options:

- Ceramic water headwork

1713 FOR GAS

1714 FOR VACUUM

1715 FOR COMPRESSED AIR

1716 FOR OTHER PRESSURE
GASES

(INDICATE GAS/FLUID)

1717 SS FOR SPECIAL WATERS

1719 PP FOR SPECIAL WATERS

1718 FOR OXYGEN



FRONT CONTROL OUTLETS

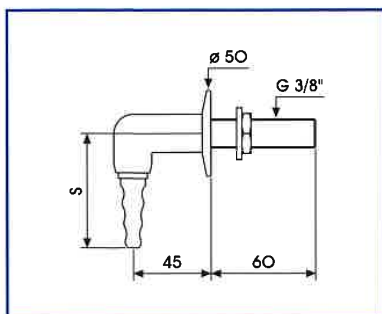

**BENCH/WALL MOUNTED
OUTLET, FOR ALL SERVICES**
(INDICATE GAS /FLUID)

- 6709** FIXED NOZZLE
S=65 mm
- 6714** REMOVABLE NOZZLE
S=70 mm

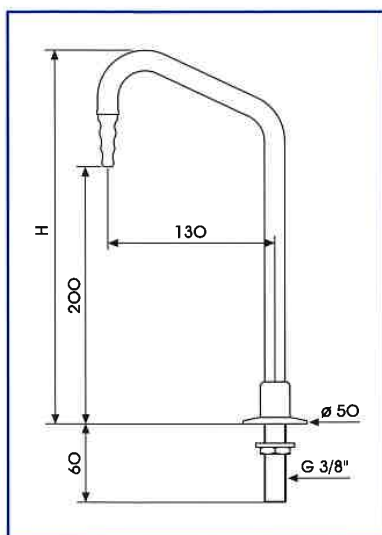

FIXED SWANNECK FOR WATER

- 6710** FIXED NOZZLE
H=290 mm
- 6711** REMOVABLE NOZZLE
H=295 mm

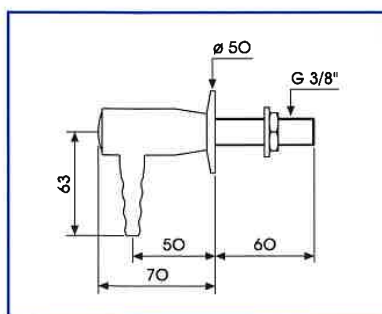

6715 BENCH/WALL MOUNTED
OUTLET FOR ALL SERVICES
(INDICATE GAS /FLUID)

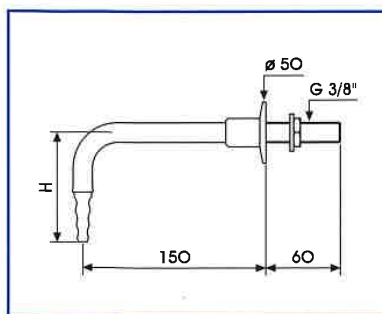

WALL MOUNTED OUTLET

- 6706** FIXED NOZZLE OUTLET
- 6716** REMOVABLE NOZZLE
- 726** PP OUTLET WITH
REMOVABLE NOZZLE
INLET G 3/8" x 12 mm
MALE H=60 mm



FRONT CONTROL OUTLETS

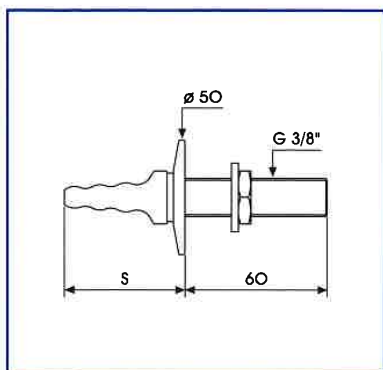

**WALL MOUNTED OUTLET
FOR ALL SERVICES**
(INDICATE GAS/FLUID)

6708 FIXED NOZZLE OUTLET

6718 REMOVABLE NOZZLE
OUTLET

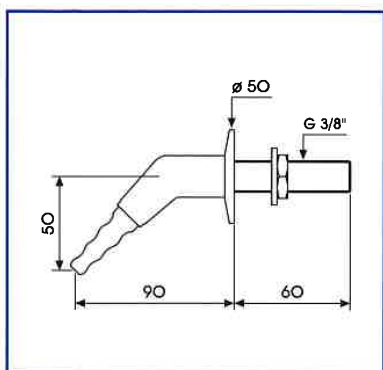

**WALL MOUNTED OUTLET AT
45° FOR ALL SERVICES**
(INDICATE GAS/FLUID)

6712 FIXED NOZZLE OUTLET

6722 REMOVABLE NOZZLE
OUTLET

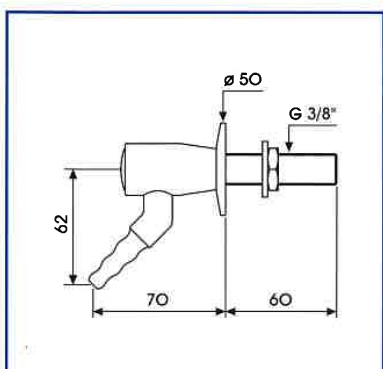

6732 WALL MOUNTED
OUTLET AT 45°,
FIXED NOZZLE FOR
ALL SERVICES
(INDICATE GAS/FLUID)

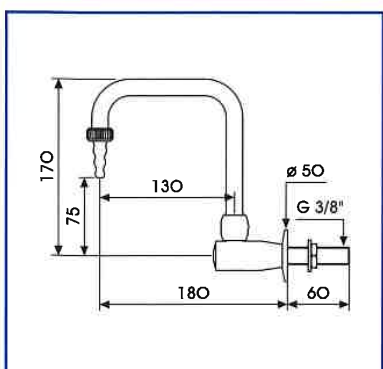

6736 SWIVEL SWANNECK
WATER OUTLET,
WALL MOUNTED,
REMOVABLE NOZZLE



CERAMIC SINKS

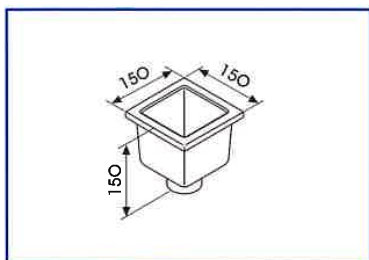

135 CERAMIC SINK 150 x 150 mm
OUTLET DIAMETER 60 mm

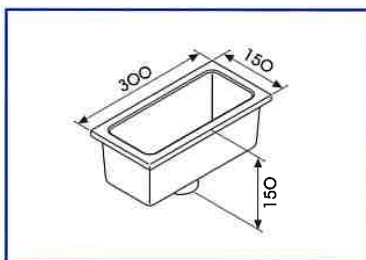

136 CERAMIC SINK 300 x 150 mm
OUTLET DIAMETER 60 mm

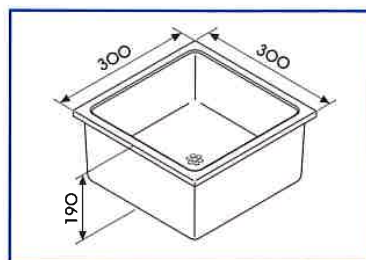

137 CERAMIC SINK 300 x 300 mm
OUTLET DIAMETER 60 mm

ELECTRIC SOCKETS

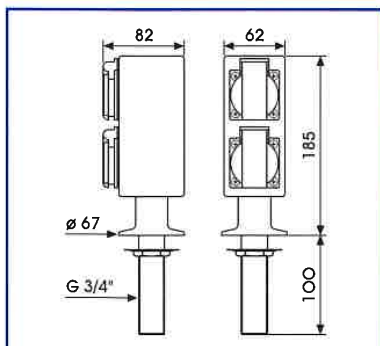

BENCH SOCKET ONE SIDE

901 TWO GANG SCHUKO

Other options:

- TWO GANG UK BS1363
- TWO GANG USA NEMA5-15
- ONE GANG Ethernet RJ45

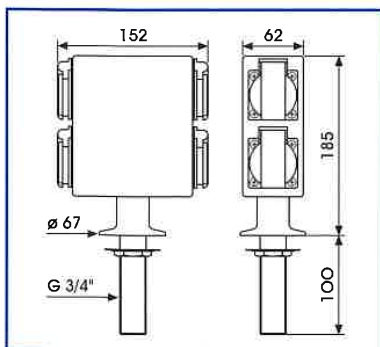

BENCH SOCKET TWO SIDES

902 FOUR GANG SCHUKO

Other options:

- FOUR GANG UK BS1363
- FOUR GANG USA NEMA5-15
- ONE GANG Ethernet RJ45



ACCESSORIES

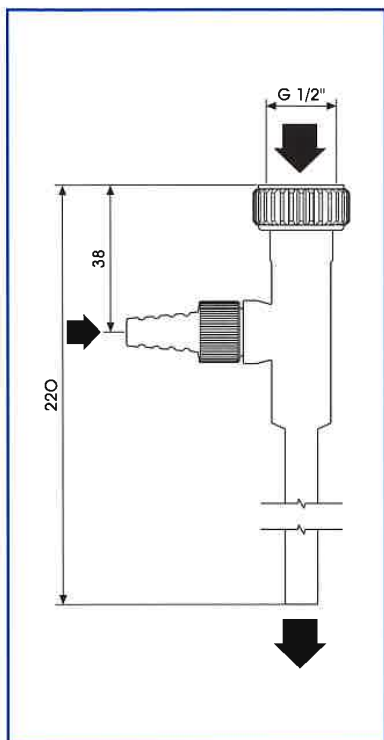

133 WATER JET VACUUM
PUMP WITH
ANTI SPLASH OUTLET

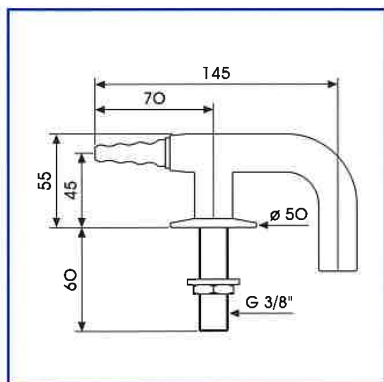

WASTE FOR HOSE
6134 FIXED NOZZLE INLET
6138 REMOVABLE NOZZLE

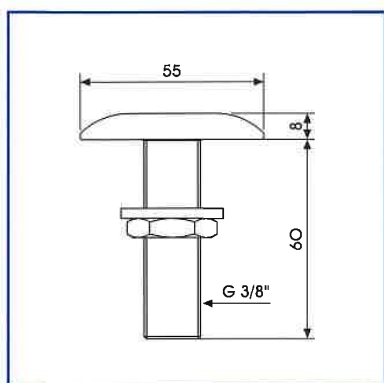

6970 BLIND FLANGE
17-22 mm



SPARE PARTS

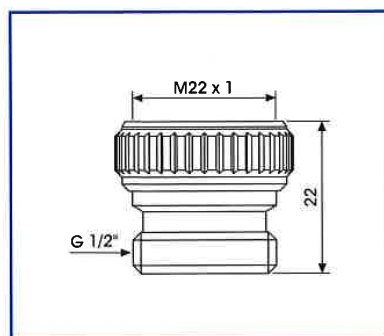

891161
NIPPLE M22 x 1
G 1/2"

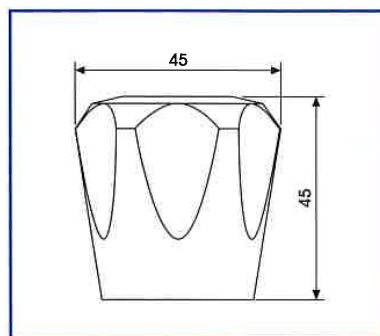

960200
STANDARD ABS
HANDLE
(INDICATE
GAS/FLUID)

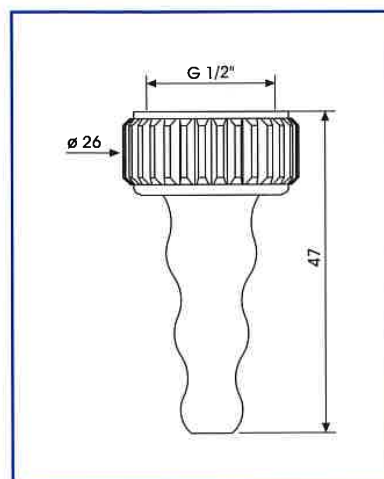

130
REMOVABLE
NOZZLE G 1/2"

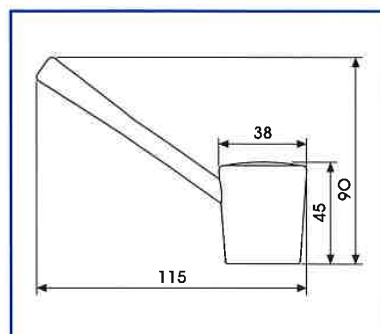

190002
WRIST LEVER

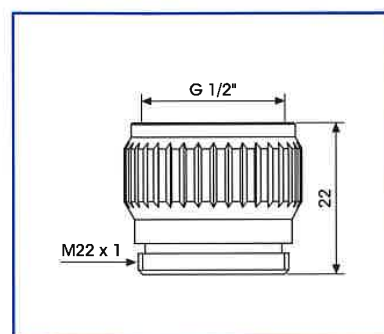

131
NIPPLE G 1/2"
M22 x 1

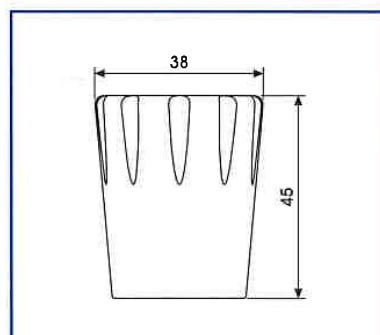

960180
POLYPROPYLENE
HANDLE
(INDICATE
GAS/FLUID)

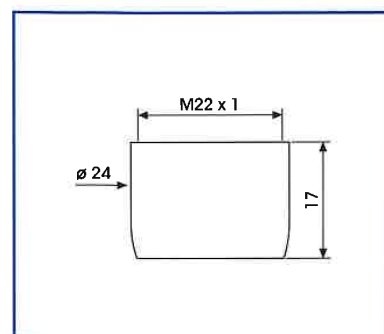

147
AERATOR
M22 x 1

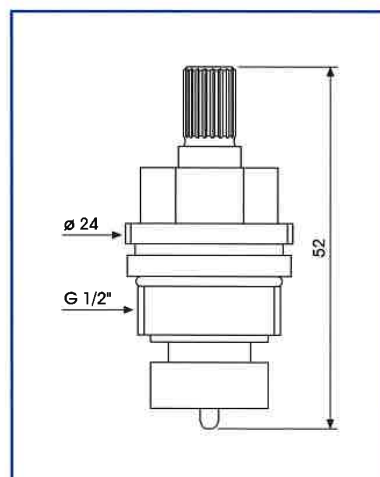

HEADWORKS
950148
COMPRESSION
WATER
950149
CERAMIC
WATER
950139
CERAMIC HOT
WATER
(LEFT WRIST LEVER)
950150
PUSH TURN GAS
950151
SPECIAL WATERS
950131
NEEDLE VALVE



DIRECTORY

CODE	PAGE	CODE	PAGE	CODE	PAGE	CODE	PAGE
115	12	6140	12	6601	21	6881	23
116	12	6141	12	6602	21	6882	23
130	32	6142	12	6603	21	6883	23
131	32	6155	12	6622	24	6884	22
133	31	6156	12	6684	22	6888	22
135	30	6157	12	6706	28	6955	9
136	30	6160	13	6708	29	6970	31
137	30	6161	13	6709	28	190002	32
147	32	6162	13	6710	28	800031 AR	20
295	26	6170	13	6711	28	800031 NN	20
298	26	6171	13	6712	29	800032 AR	20
310	14	6172	13	6714	28	800032 NN	20
311	14	6190	13	6715	28	800033 AR	20
312	14	6191	13	6716	28	800033 NN	20
320	14	6192	13	6718	29	800034 AR	20
726	28	6198	25	6721	8	800034 NN	20
812	13	6199	25	6722	29	800035 AR	16
813	13	6201	7	6731	15	800035 NN	16
814	13	6202	7	6732	29	800036 AR	16
901	30	6203	7	6736	29	800036 NN	16
902	30	6216	11	6741	22	891161	32
955	9	6222	11	6751	22	950131	32
1701	27	6232	18	6761	22	950139	32
1703	27	6242	24	6781	22	950148	32
1704	27	6252	24	6801	21	950149	32
1705	27	6262	24	6802	8	950150	32
1706	27	6282	24	6803	21	950151	32
1707	27	6284	8	6808	21	960180	32
1708	27	6299	26	6810	9	960200	32
1711	27	6301	19	6815	10		
1713	27	6302	19	6816	10		
1714	27	6303	19	6817	10		
1715	27	6304	19	6818	9		
1716	27	6322	18	6822	24		
1717	27	6384	15	6831	17		
1718	27	6401	21	6832	17		
1719	27	6402	21	6833	17		
6101	5	6403	21	6838	16		
6102	5	6416	11	6841	23		
6103	5	6422	24	6842	23		
6104	5	6432	18	6843	23		
6105	5	6442	24	6848	22		
6106	5	6452	24	6851	23		
6107	5	6462	24	6852	23		
6120	6	6482	24	6853	23		
6122	6	6484	22	6858	22		
6124	6	6501	21	6861	23		
6126	6	6502	21	6862	23		
6128	7	6503	21	6863	23		
6134	31	6522	24	6868	22		
6138	31	6584	22	6870	9		



CARLOS ARBOLES S.A
LABORATORY TAPS

www.carlosarboles.com

総輸入元

ユラボジャパン株式会社

本社

〒594-1144 大阪府和泉市テクノステージ1丁目3-17

TEL:0725-51-3401(代表) FAX:0725-51-3411

TEL:0725-54-1900(サービス)

東京営業所

〒113-0033 東京都文京区本郷2丁目15-10 第2大平ビル5F

TEL:03-5802-4600 FAX:03-5802-4601

CORTINA
DISEÑO COMUNICACION
partidas@carlosarboles.com
© copyright 2016 CARLOS ARBOLES S.A



CGG.I.2016



CARLOS ARBOLES S.A

LABORATORY TAPS

Compositor Narvaez, 10 P. I. CAN JARDI
08191 RUBI (Barcelona) SPAIN
Telephone +34 935 860 780
Fax +34 936 973 226
info@carlosarboles.com